

Coact assembly

Tools required

1. Drill

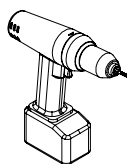

Media unit assembly

1. Begin by placing the back panel on a flat non-marring surface, making sure the pre-drilled holes are facing up. Next, position the box platform onto the back panel by aligning the mounting holes with the pre-drilled holes on the back panel.
2. Using the screws from the HK-104 kit, fasten the box platform to the back panel, making sure the bottom edges are flush and that the box platform is centered, as shown above. If necessary loosen the screws slightly, adjust the location, and re-tighten the screws.

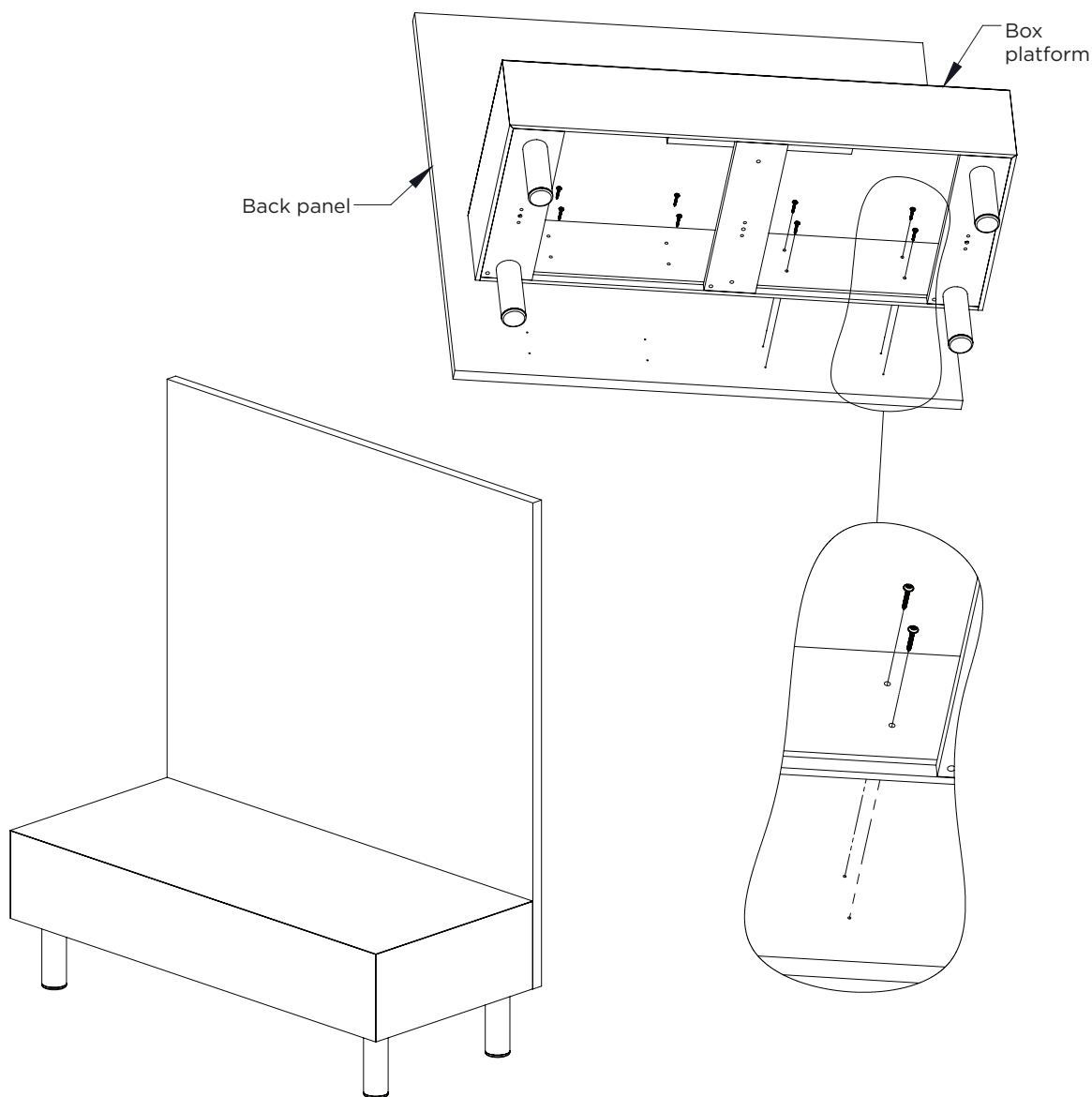

Tools required

1. Drill

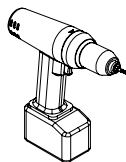

Media unit assembly instructions

1. Begin by placing the back panel on a flat non-marring surface, making sure the pre-drilled holes are facing up. Next, position the box platform onto the back panel by aligning the mounting holes with the pre-drilled holes on the back panel.
2. Using the screws from the HK-104 kit, fasten the box platform to the back panel, making sure the bottom edges are flush and that the box platform is centered, as shown above. If necessary loosen the screws slightly, adjust the location, and re-tighten the screws.
3. With the box platform fastened, the shelves can now be secured to the back panel by fastening the screws from the HK-15 kit into the pocket bores as shown below.

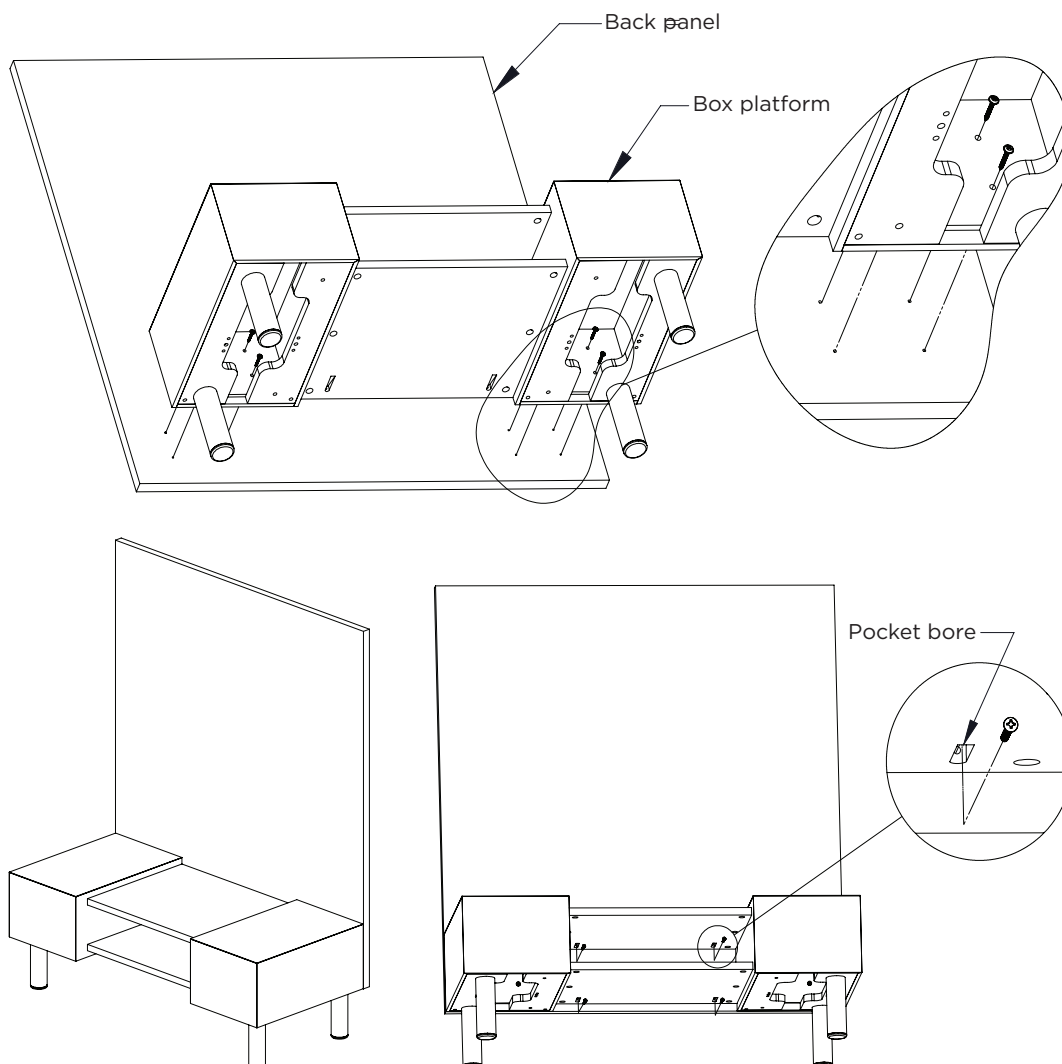

Tools required

1. Tape measure
2. Utility knife
3. Square

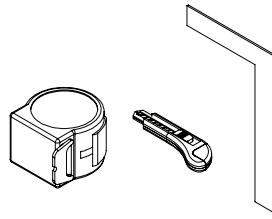

Wire manager installation instructions

NOTE: Depending on how your Media Unit is being utilized, it could require cutting the Wire Manager to the appropriate length.

1. If it is necessary to cut the Wire Manager, measure to the desired length, and using a square and utility knife, score the Wire Manager multiple times along the top face. Once scored, cut completely through. Repeat this step for the remaining faces.
2. With the Wire Manager cut to the correct length, peel back the paper wrapper on the back side to expose the adhesive, as shown above. Place the Wire Manager onto the back panel of the Media Unit, making sure it is centered and covering the grommet opening on the shelf. Press firmly on the flanges to ensure a good contact.

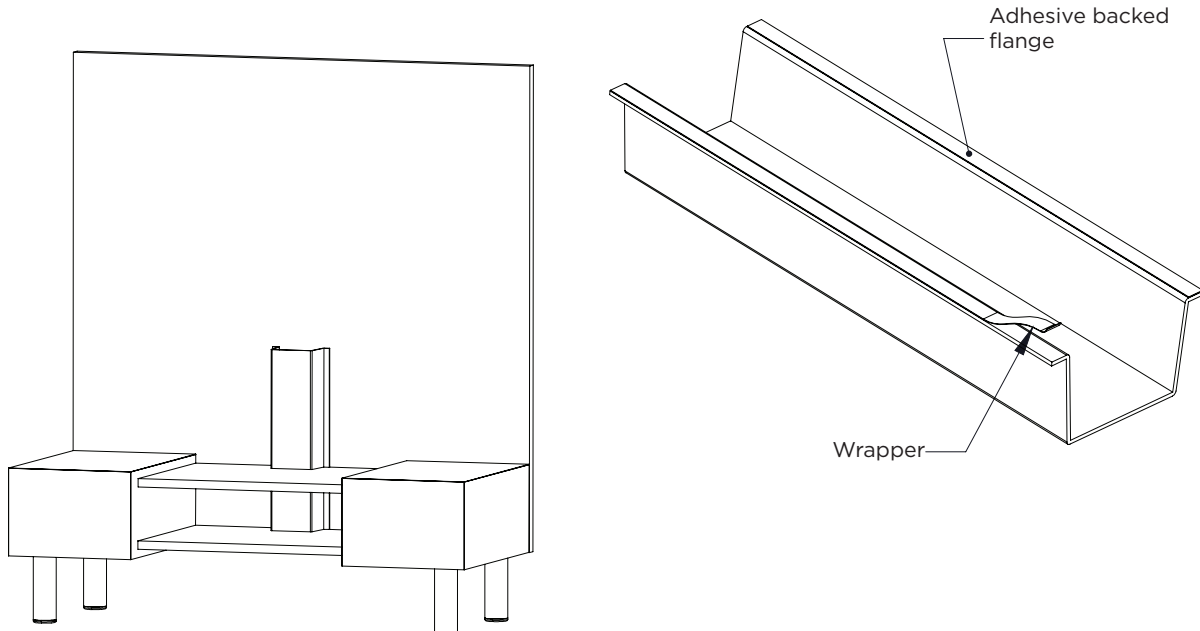
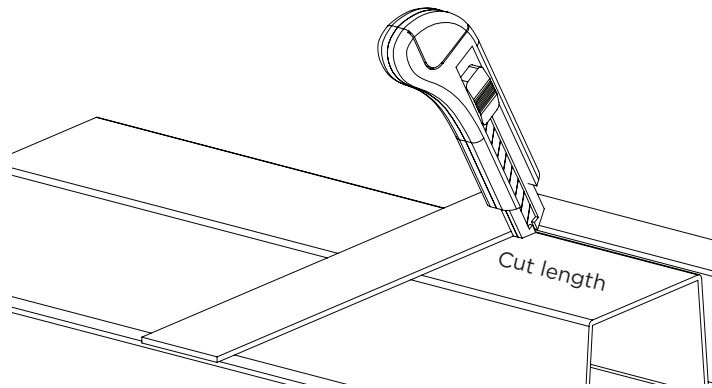

Tools required

1. Drill

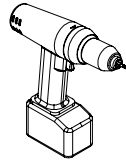

Corner media unit installation instructions

1. Begin by assembling the “L” shape back panel as illustrated in the upper most view. Place the back panel onto the end panel, making sure the shoulder screw is inserted into the pocket on the end panel and above the slot opening of the mod-eez clip as shown in the detail view above. When the screw and clip are engaged, gently tap the back panel down until both panels are flush with each other.
NOTE: The panel will fit tighter the farther it travels downward. If necessary use a rubber mallet, or loosen the shoulder screws 1/4 turn to ease the panel attachment.
2. Next, position the box platform onto the assembled back panel by aligning the mounting holes with the pre-drilled holes on the assembled back panel. Using the screws from the HK-104 kit, fasten the box platform to the assembled back panel, making sure the box platform is flush, or just inside of the assembled back panel, as shown above. If necessary loosen the screws slightly, adjust the location, and re-tighten the screws.

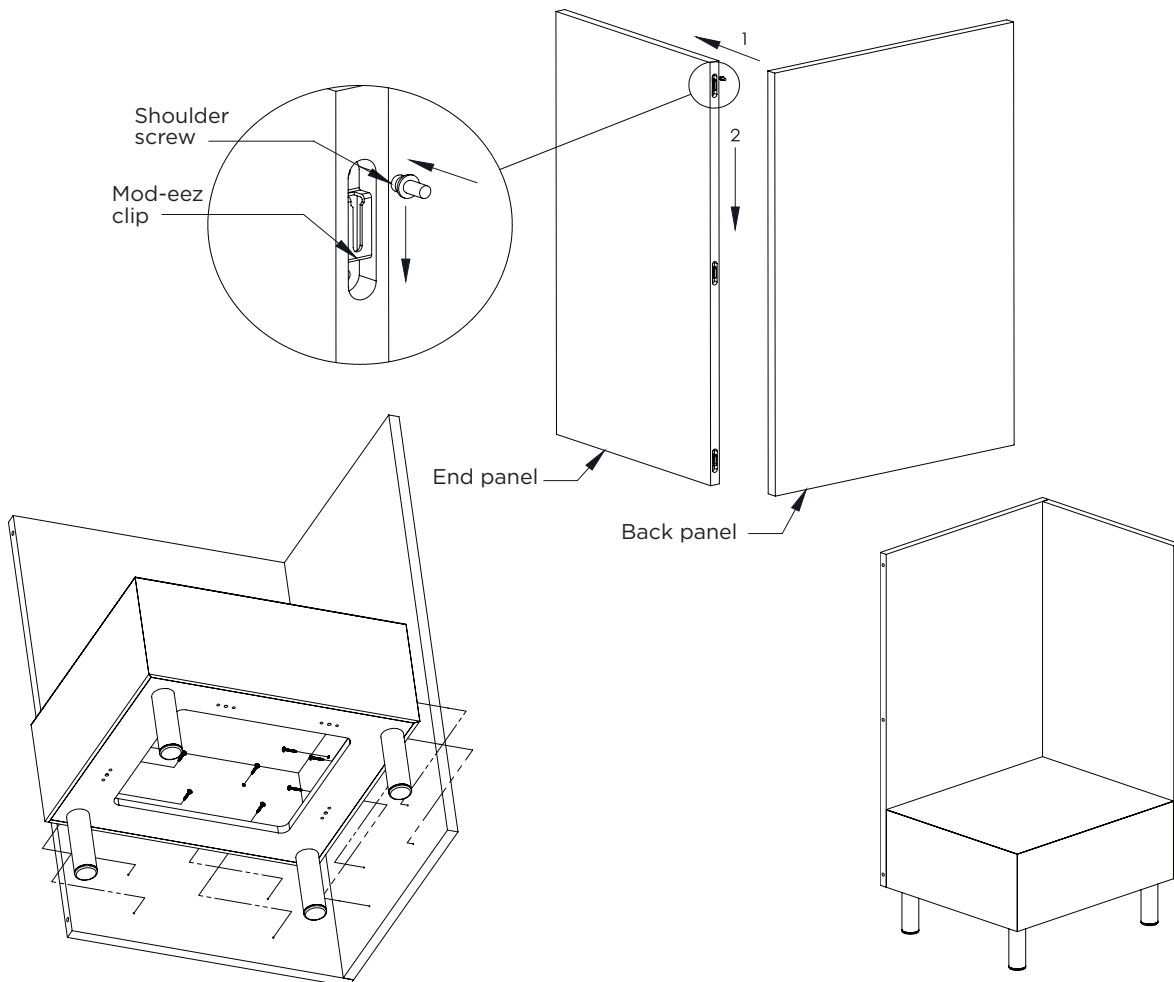

Tools required

1. Drill
2. Tape measure

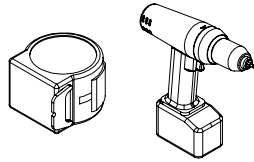

Runoff table installation instructions

NOTE: It is recommended to install the Runoff Table after the Media Unit has been placed in its final resting position.

1. Begin by placing the worksurface on a flat non-marring surface, making sure the pre-drilled holes are facing up. Next, place the worksurface brackets onto the worksurface and align the mounting holes to the pre-drilled holes. Fasten the brackets down using the supplied screws from the HK-125 kit, making sure every mount hole is utilized.
2. Next, place the table base onto the worksurface. Depending on which base style was chosen, two of the four pre-drilled holes on the worksurface will align with the mount holes on the base mount plate, as shown above. Fasten the base down using the screws supplied with the base, making sure every mount hole is utilized.

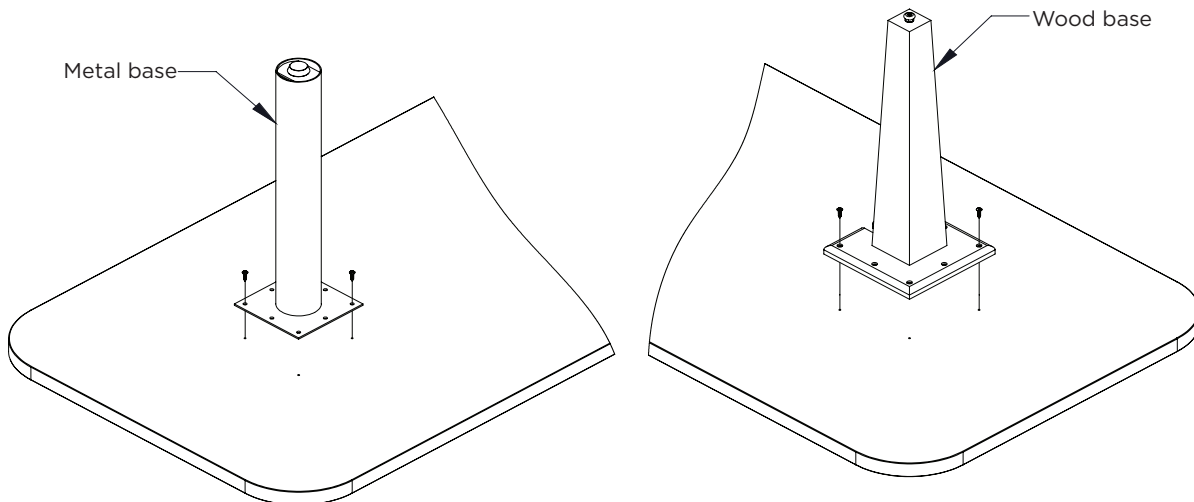
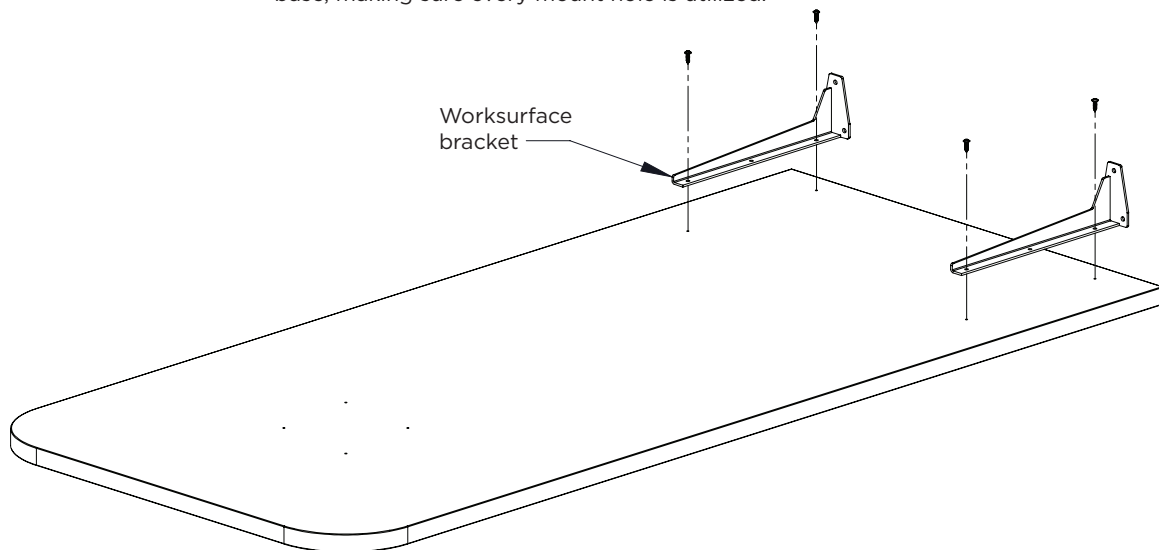

Runoff table installation instructions continued

3. Using the view above, measure the distance required for your Runoff table height and scribe a temporary line to mark the location for the bottom of the worksurface. This can be done by measuring from the floor, or from the top of the box platform (Verify that box platform height is 13-3/4", as shown above).
4. Making sure the worksurface is centered with the Media Unit and the bottom edge aligns with the scribed line, fasten the Runoff table to the back panel of the media unit using the remaining screws from the HK-125 kit.

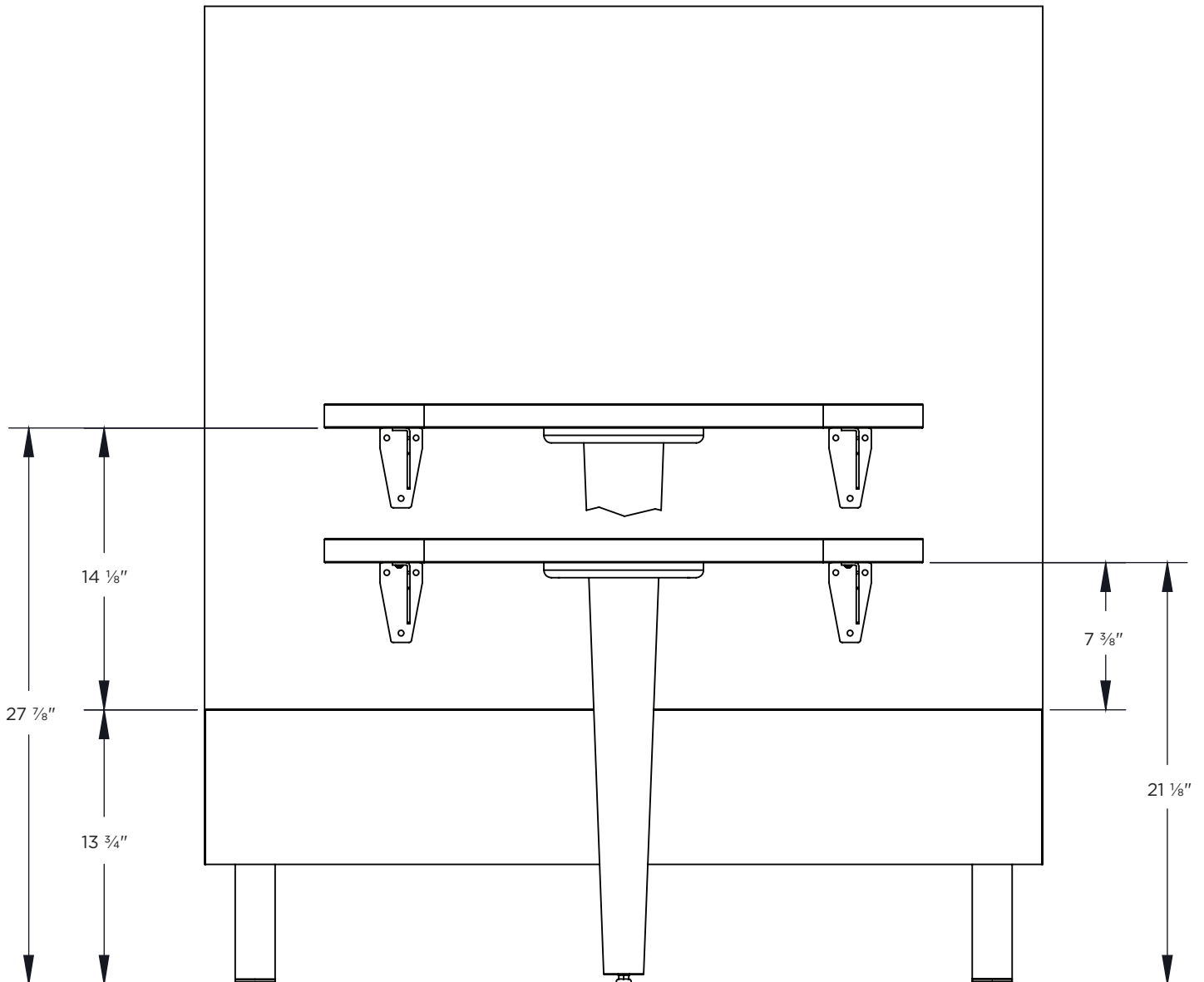

Media unit ganging connection

1. Starting with one of the Media Units, insert the dowel pins from the HK-126 kit halfway into the bored holes on the back panel, as shown above.
2. Next, slide the adjoining Media Unit against the connecting Media Unit, making sure the dowel is inserted into the aligning hole. Refer to the "Ganging Bracket" installation sheet to complete the "Lounge Ganging option" installation of the Media Units.

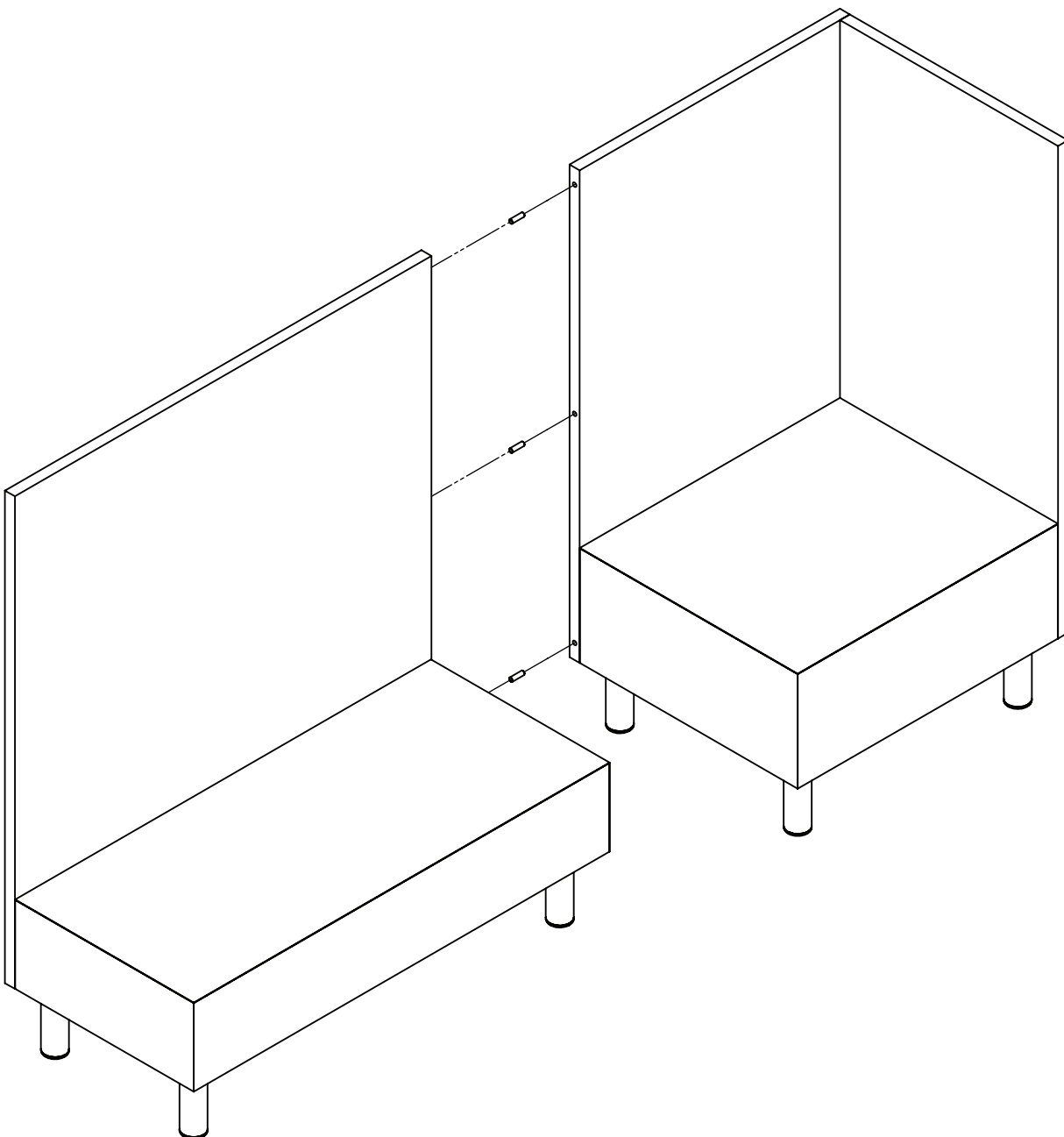

Rear shelf assembly

1. Thread shelf post into holes on back.
NOTE: Placing a screwdriver thru hole works well to turn them into place.
2. Install shelf bracket. Lock in place with set screw provided.
3. Install shelf with 1/4-20 bolts provided from underside of shelf surface.

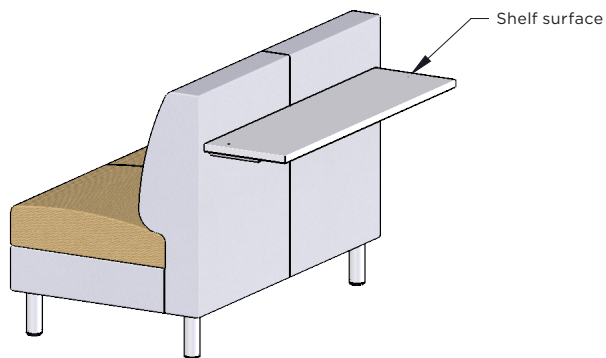
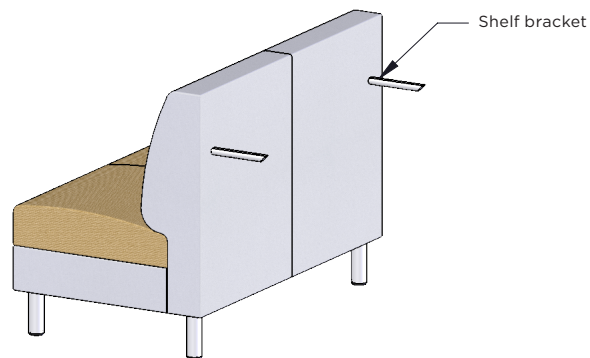
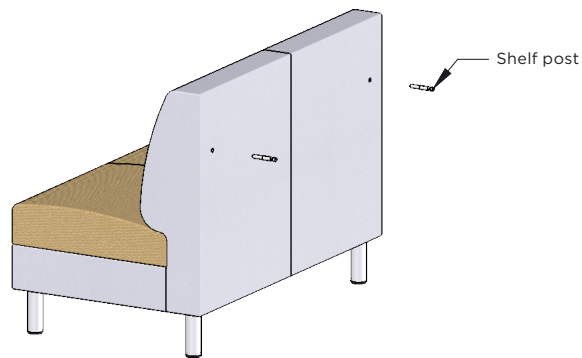

Rear shelf assembly

1. Thread shelf post into holes on back.
NOTE: Placing a screwdriver thru hole works well to turn them into place.
2. Remove the shelf brackets from the surface and install shelf bracket. Lock in place with set screw provided.
3. Install shelf with 1/4-20 bolts provided from underside of shelf surface. Run a finger along the otback to locate an inner vertical support rail and attach brackets as shown.

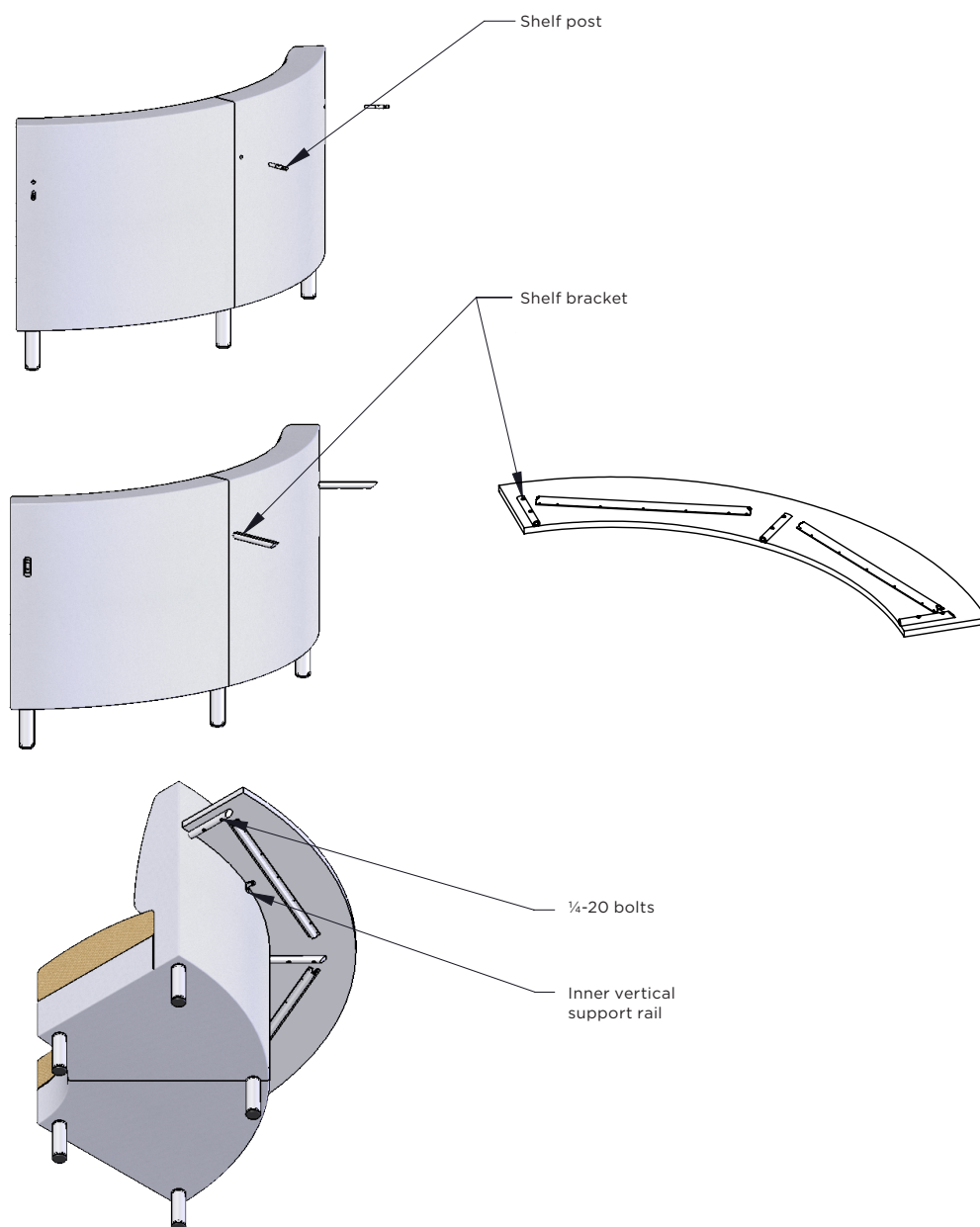

Square corner surface assembly

1. Pry up on the top along back sides of unit being careful to not damage the fabric.
2. New top will snap in place by hand.

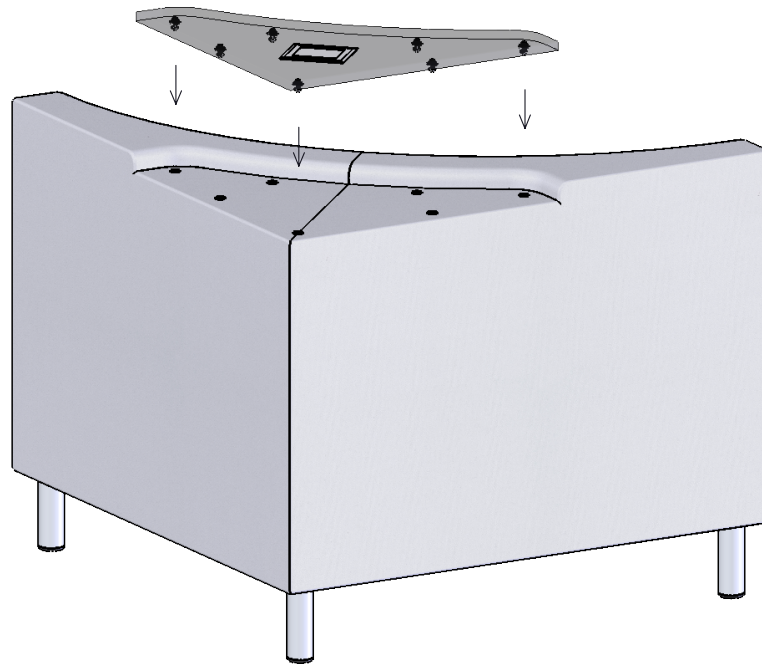

Leg assembly

1. Legs thread in and out of frame by hand.
2. Tapered legs are turned snug and held square to the frame with L-bracket with wood screws as shown in view 1-1.

NOTE: Install flat washer between leg and frame.

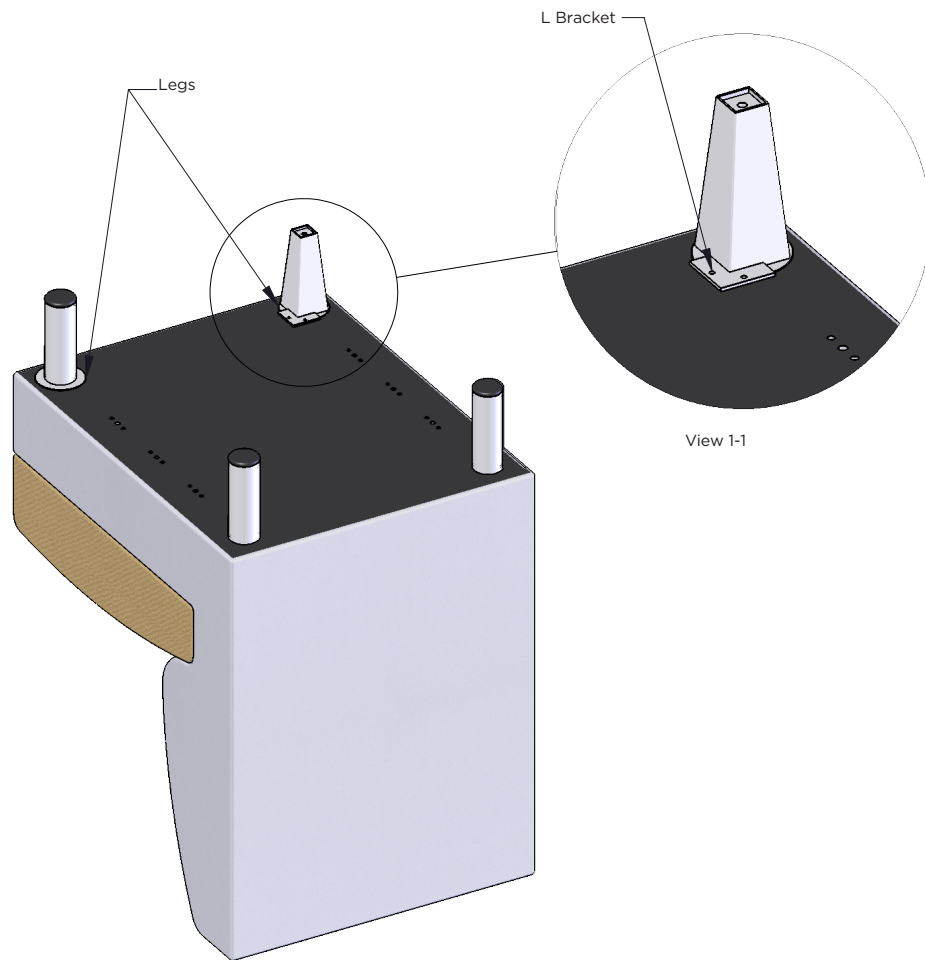

Table top assembly

1. Top is held in place with spring steel brackets
2. Using a tool that will not damage the fabric or top, slowly pry up between seat and chassis
3. Pry in several places around the top
4. Center to pover chassis and press in place

