

Eleven wood assembly



Important safety instructions

When using an electrical furnishing, basic precautions should always be followed, including the following:

This furnishing is made for commercial use only.

Read all instructions before using this furnishing:

DANGER

To reduce the risk of electrical shock:

1. Always unplug this furnishing from the electrical outlet before cleaning.

WARNING

To reduce the risk of burns, fire, electric shock, or injury to persons:

1. Unplug from outlet before putting on or taking off parts.
2. Close supervision is necessary when this furnishing is used by, or near children, invalids, or disabled persons.
3. Use the furnishing only for its intended use as described in these instructions.
Do not use attachments not recommended by the manufacturer.
4. Never operate this furnishing if it has a damaged cord or plug, if it is not working properly, if it has been dropped or damaged, or dropped in water. Return the furnishing to a service center for examination and repair.
5. Keep the cord away from heated surfaces.
6. Do not use outdoors.
7. Use only SJT 18 AWG cord.
8. Risk of injury. Maximum load 75 pounds.

To reduce the risk of electric shock, this furnishing has a polarized plug (one blade is wider than the other). This plug will fit in a polarized outlet only one way. If the plug does not fit fully in the outlet, reverse the plug. If it still does not fit, contact a qualified electrician to install the proper outlet. Do not change the plug in any way.

Note – servicing is only to be performed by an authorized representative.

Servicing of double-insulated products

In a double-insulated product, two systems of insulation are provided instead of grounding. No grounding means is provided on a double-insulated product, nor is a means for grounding to be added to the product. Servicing a double-insulated product requires extreme care and knowledge of the system, and is to be done only by qualified service personnel. Replacement parts for a double-insulated product must be identical to the parts they replace. A double-insulated product is marked with the words “DOUBLE INSULATION” OR “DOUBLE INSULATED”. The symbol (square within a square) is also able to be marked on the product.

Save these instructions



Table of Contents

2	Important safety instructions
3	Table of contents
4-5	Corner leg assembly
6	End leg assembly
7	End leg with extensions assembly
8	Intermediate leg assembly
9	Footrail assembly
10-11	Standing height footrail with two piece top assembly
12	Library table tackboard assembly
13-15	Wire management assembly

Corner leg assembly

Tools required:

- ½" Combination wrench
- Tape measure
- Cordless driver or impact driver

1. Remove the hex nuts and flat washers from the threaded studs on each of the table legs.
2. Attach the leg to the frame assembly by inserting the threaded studs into the corresponding holes in the frame as shown in the view 1-1.
3. Reattach the flat washer and hand tighten the hex nut onto the threaded stud
4. Repeat steps 1 through 3 for each of the remaining legs
5. Once all legs have been attached, fully tighten all the hex nuts, etc as shown in view 1-2

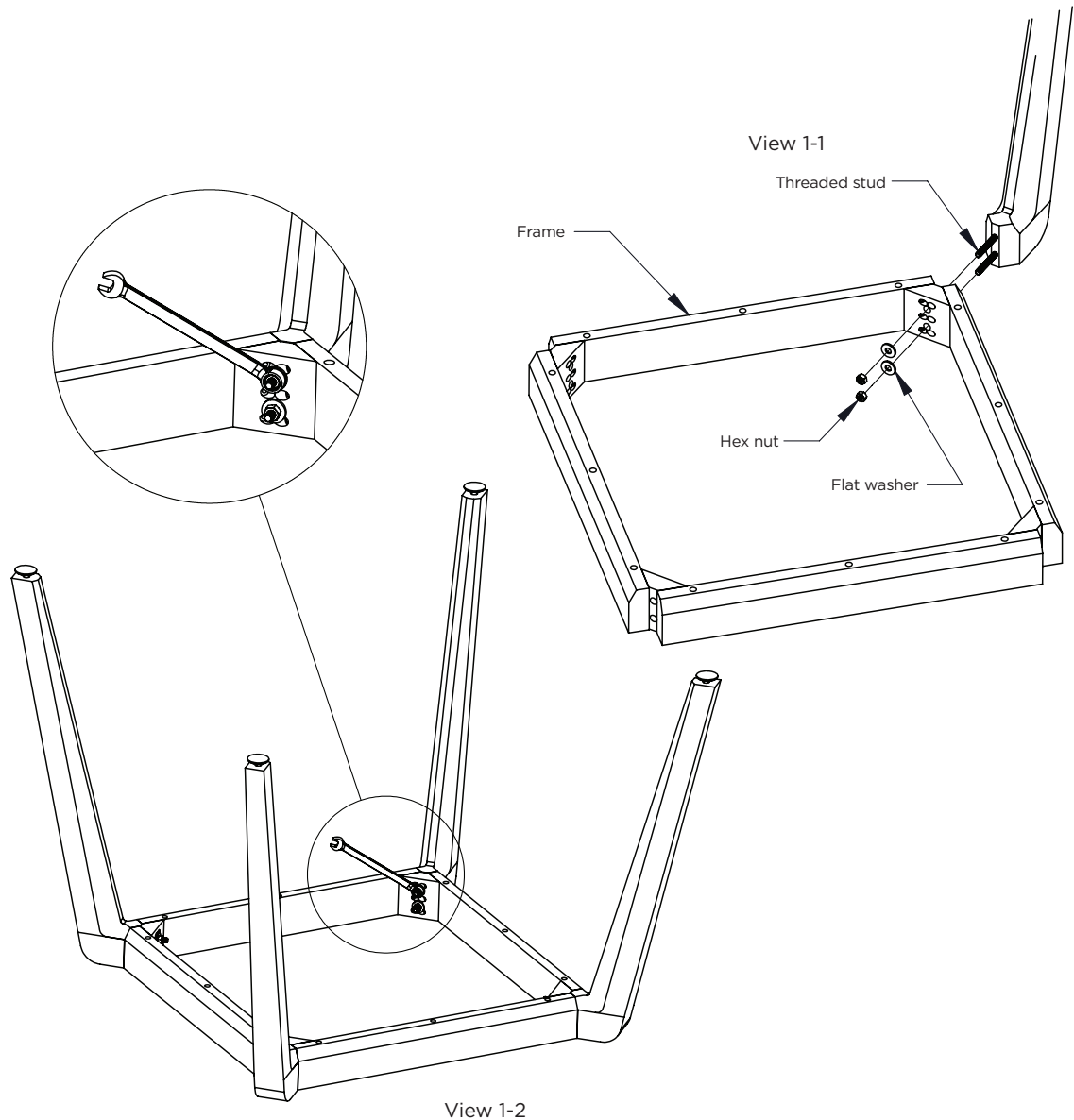

66" round and square table assembly

Tools required:

- ½" Combination wrench
- Tape measure
- Cordless driver or impact driver

6. Place the frame onto the bottom of the worksurface
7. Position the frame so that it is completely centered onto the worksurface, making sure that "dimension A" is the same value on all four sides
8. Secure the frame to the worksurface by fastening the supplied screws through the mounting holes in the frame and into the worksurface.

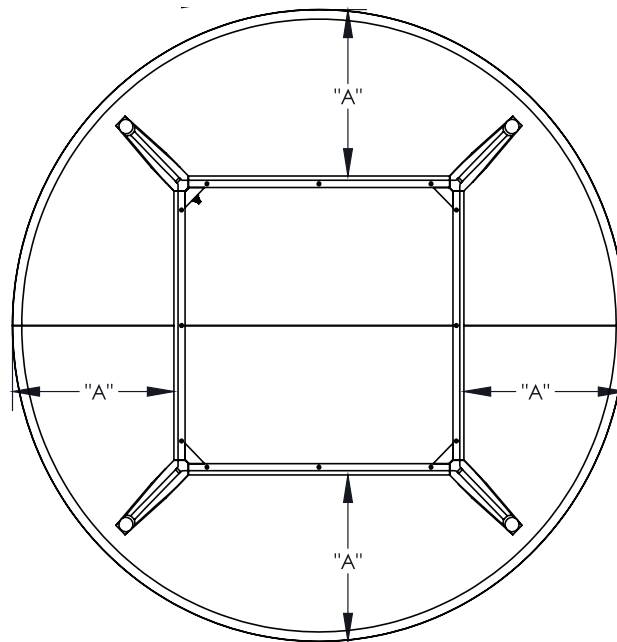

View 2-1

End leg assembly

Tools required:

- ½" Combination wrench

1. Locate the large diameter hole on top of the end legs
2. Drop the threaded cross dowel into the hole, making sure the slotted end is facing up and insert the threaded rods into the clearance hole in the leg and fasten it halfway into the cross dowel as shown in view 1-1
3. Attach the legs to the frame rails making sure the holes in the leg align with the dowel pins in the frame rail and that the threaded rod in the leg can be inserted into the frame rail. Locate the "D" shape pockets inside the frame rails and attach the rectangular washer, followed by the flange nut. Tighten the nut using a ½" wrench as shown in view 1-2
4. The frame is now fully assembled and can be mounted to the worksurface. Verify the frame is centered completely and fasten it to the worksurface using the supplied screws.

NOTE: If your table has intermediate legs, they should be assembled prior to installing the end legs.

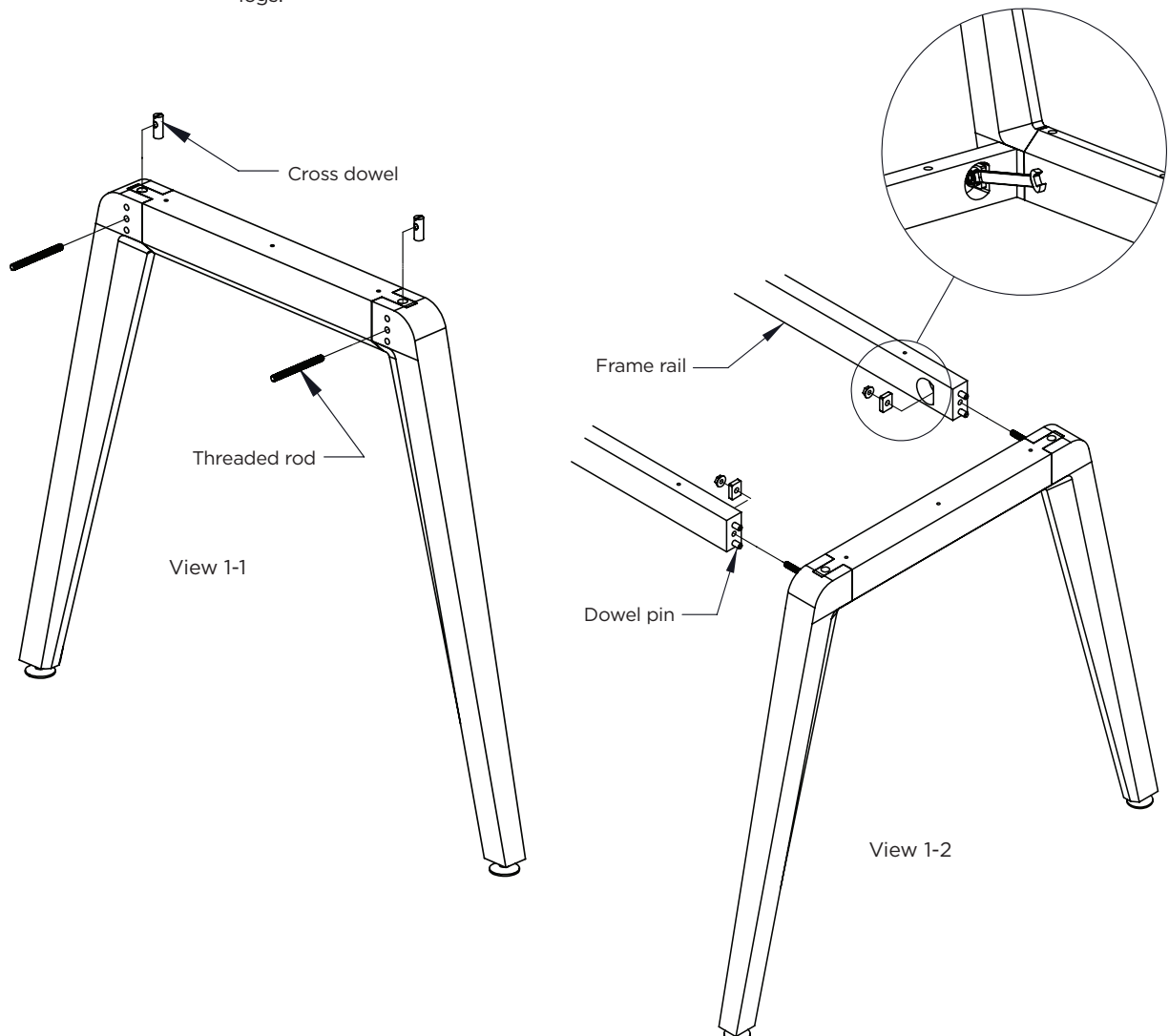

End leg with extensions assembly

Tools required:

- ½" Combination wrench

1. Drop the threaded cross dowel into the hole on top of the extension, making sure the slotted end is facing up. Then insert the threaded rod into the clearance hole on front of the extension and fasten it halfway into the cross dowel as shown in view 1-1
2. Attach the extensions to the legs making sure the holes in the leg align with the dowel pins in the extension and that the threaded rod in the extension can be inserted into the clearance hole on the leg as shown in view 1-2.
3. Attach the legs to the frame rails, once again making sure all the corresponding holes align with one another. Locate the "D" shape pockets inside the frame rails and attach the rectangular washer, followed by the flange nut. Tighten the nut using a 1/2" wrench as shown in view 1-2.

The frame is now fully assembled and can be mounted to the worksurface. Verify the frame is centered completely and fasten it to the worksurface using the supplied screws.

NOTE: If your table has intermediate legs, they should be assembled prior to installing the end legs.

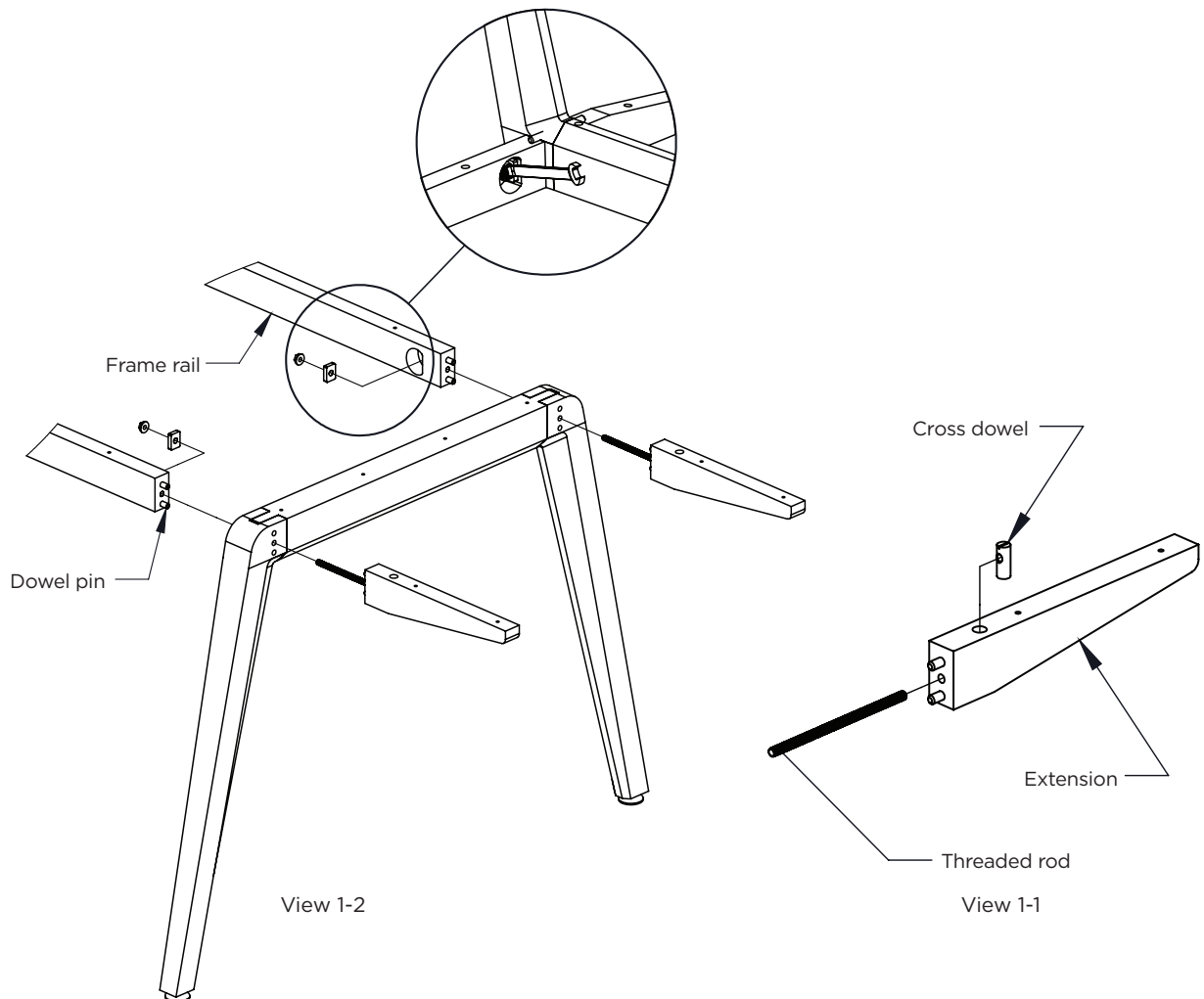

Intermediate leg assembly

Tools required:

- 1/2" Combination wrench

1. Insert the threaded rods into the clearance hole in the leg making sure there are equal amounts of visible threads shown on each side as shown in view 1-1
2. Attach the legs to the frame rails making sure the holes in the leg align with the dowel pins in the frame rail and that the threaded rod in the leg can be inserted into the frame rail. Locate the "D" shape pockets inside the frame rails and attach the rectangular washer, followed by the flange nut as shown in view 1-1. Repeat for the remaining frame rails.
3. After the frame rails have been installed on both sides of the leg, the flange nuts can be fully tightened using a 1/2" wrench.

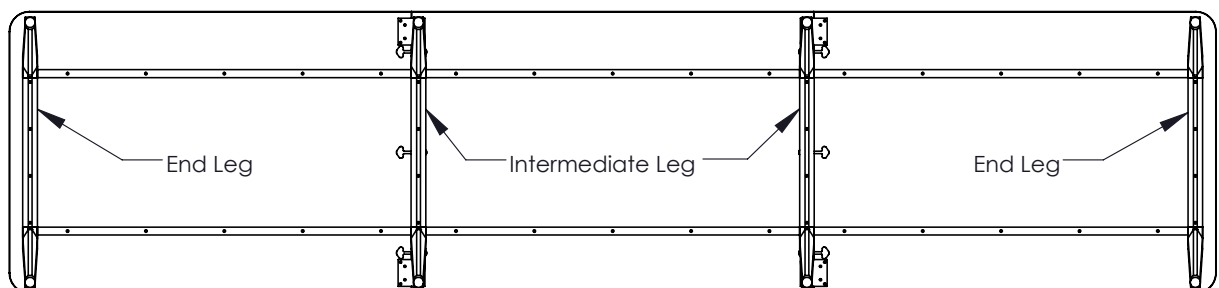
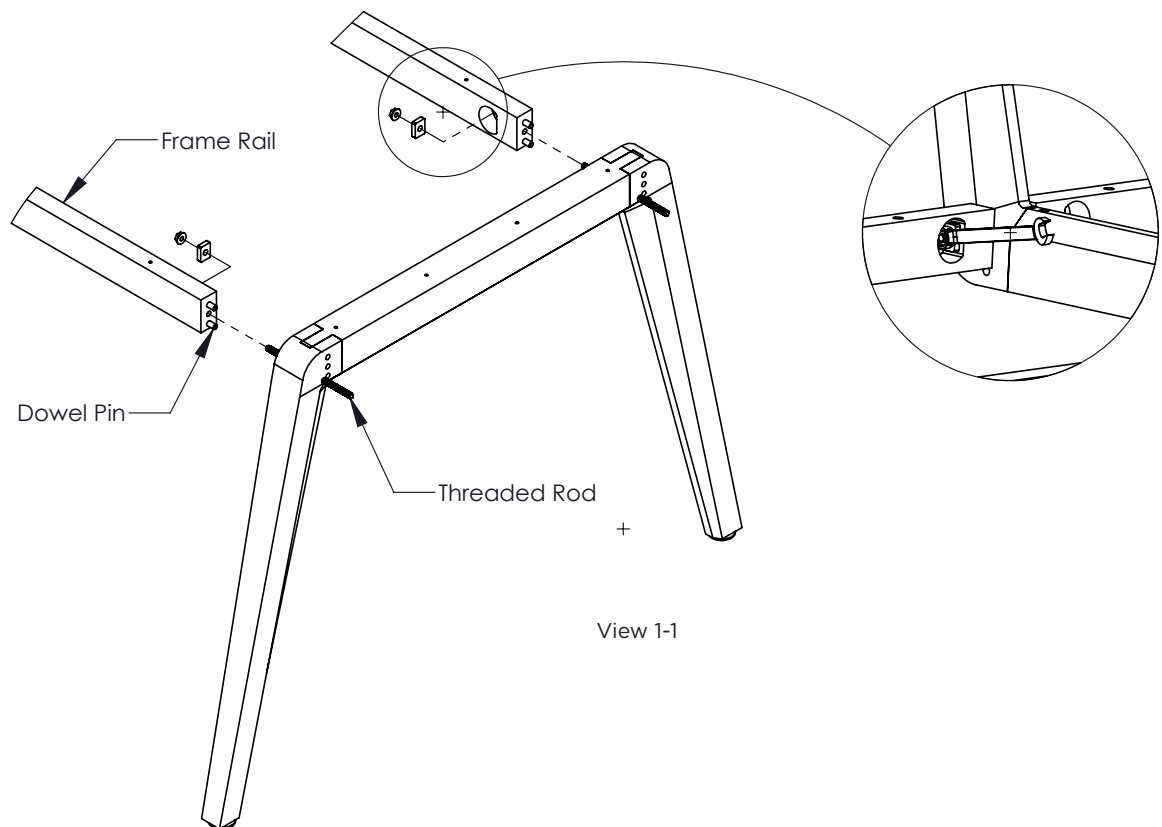

Foot rail assembly

Tools required:

- ½" Combination wrench
- ⅝" - ⅜" Allen wrenches

1. Locate the (2) holes bored on the bottom of the cross rail on the end legs. Insert a cross dowel into the hole, making sure the slotted end of the cross dowel is facing towards you as shown in view 1-1.
2. Insert the 4" long screw from the HK-128 kit into the mount puck and thread into the cross dowel. Make sure the threaded holes of the mount puck are aligned vertically with the holes in the cross rail and fully tighten the screw as shown in view 1-2
3. Align and insert the wood frame rails onto the legs, making sure the foot rails are being inserted onto the mount pucks at the same time, as shown in the view 1-3. After the frame has been assembled and the frame rails fully tightened, secure the foot rails by fastening the flat head screws from the HK-128 kit through the counting holes of the foot rails and into the mount pucks as shown in view 1-4.

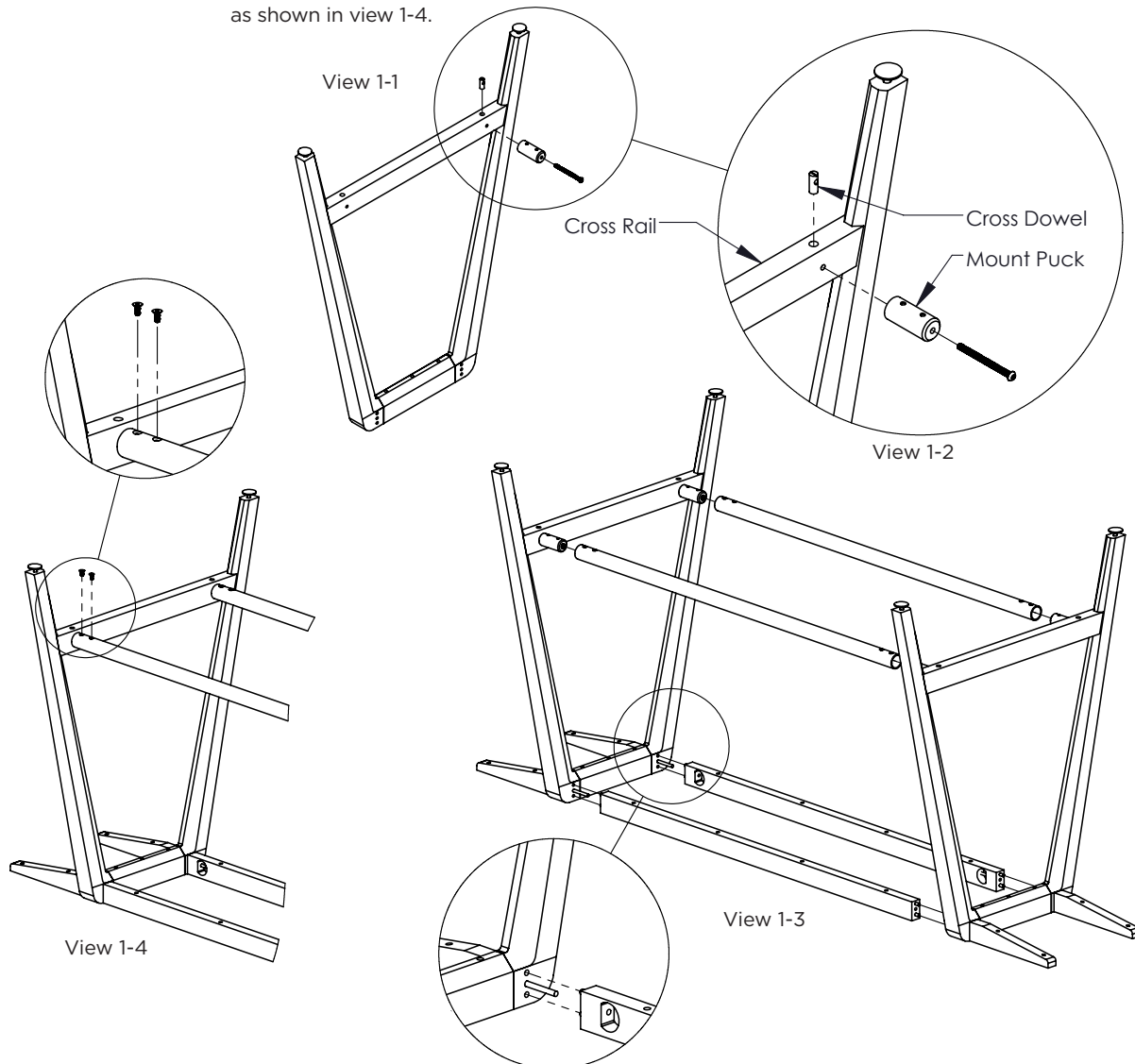

Standing height foot rail with two-piece top assembly

Tools required:

- ½" Combination wrench
- ⅝" - ⅜" Allen wrenches

1. Locate the (2) holes bored on the bottom of the cross rail on the end legs. Insert a cross dowel into the hole, making sure the slotted end of the cross dowel is facing towards you as shown in view 1-1.
2. Insert the 4" long screw from the HK-128 kit into the mount puck and thread into the cross dowel. Using the view 1-1, make sure the threaded holes of the mount puck are aligned vertically with the holes in the cross rail and fully tighten the screw.
3. Locate the (2) holes bored on the bottom of the cross rail on the intermediate leg. Insert the 8" threaded stud from the HK-131 kit into the hole, followed by a mount puck and hex nut as shown in view 1-2. When fastening the hex nuts, thread one side until the nut is flush, or just slightly past the end of the stud. This should allow enough exposed threads to fully tighten the opposite side.

Note: When tightening the hex nuts, make sure the threaded holes of the mount puck are aligned vertically with the holes in the cross rail.

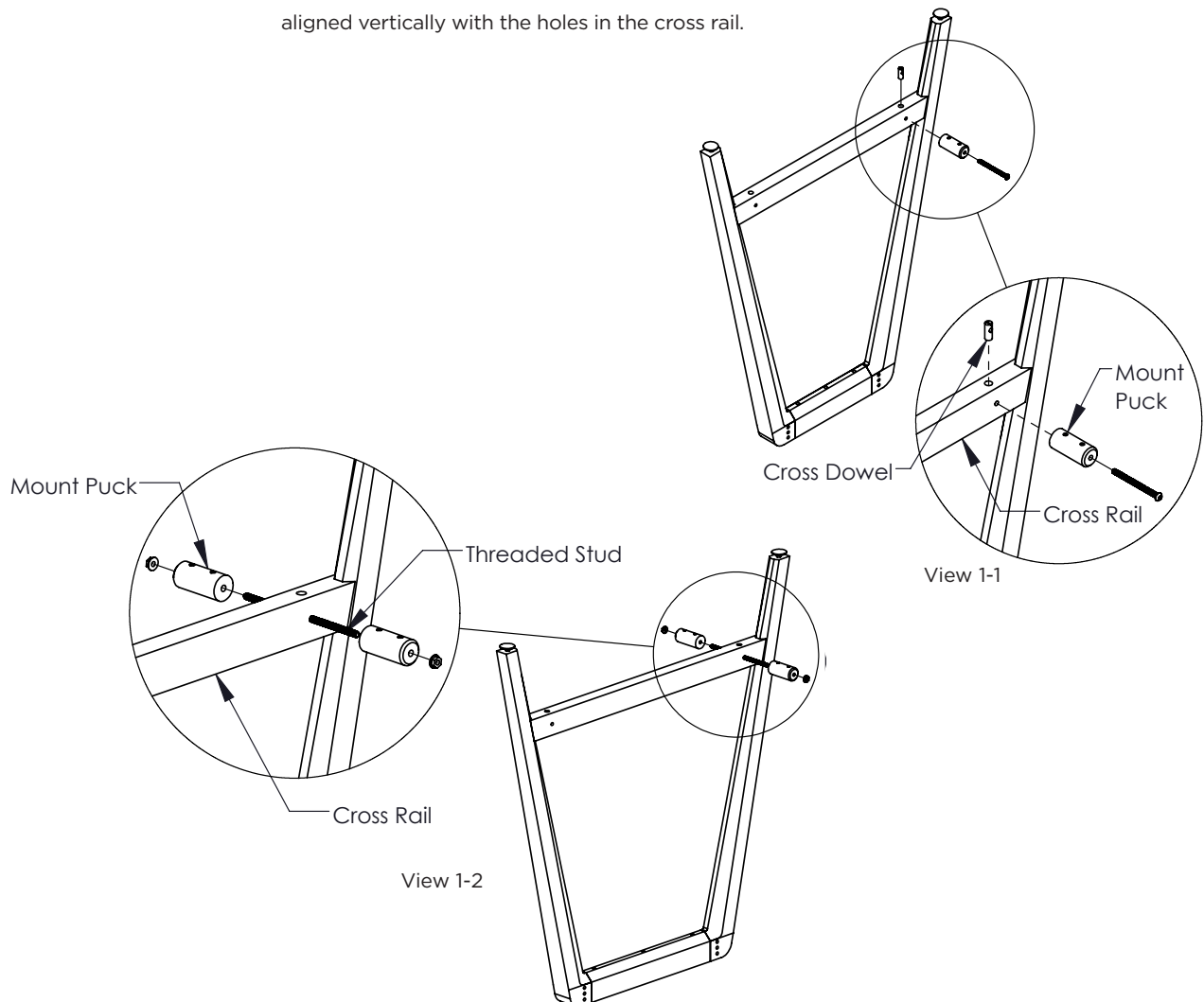

Standing height foot rail with two-piece top assembly

Tools required:

- ½" Combination wrench
- ⅝" - ⅜" Allen wrenches

4. Align and insert the wood frame rails onto the legs, making sure the foot rails are being inserted onto the mount pucks at the same time, as shown in the view above.
5. After the frame has been assembled and the frame rails fully tightened, secure the foot rails by fastening the flat head screws from the HK-128 & HK-131 kit through the mounting holes of the foot rails and into the mount pucks.

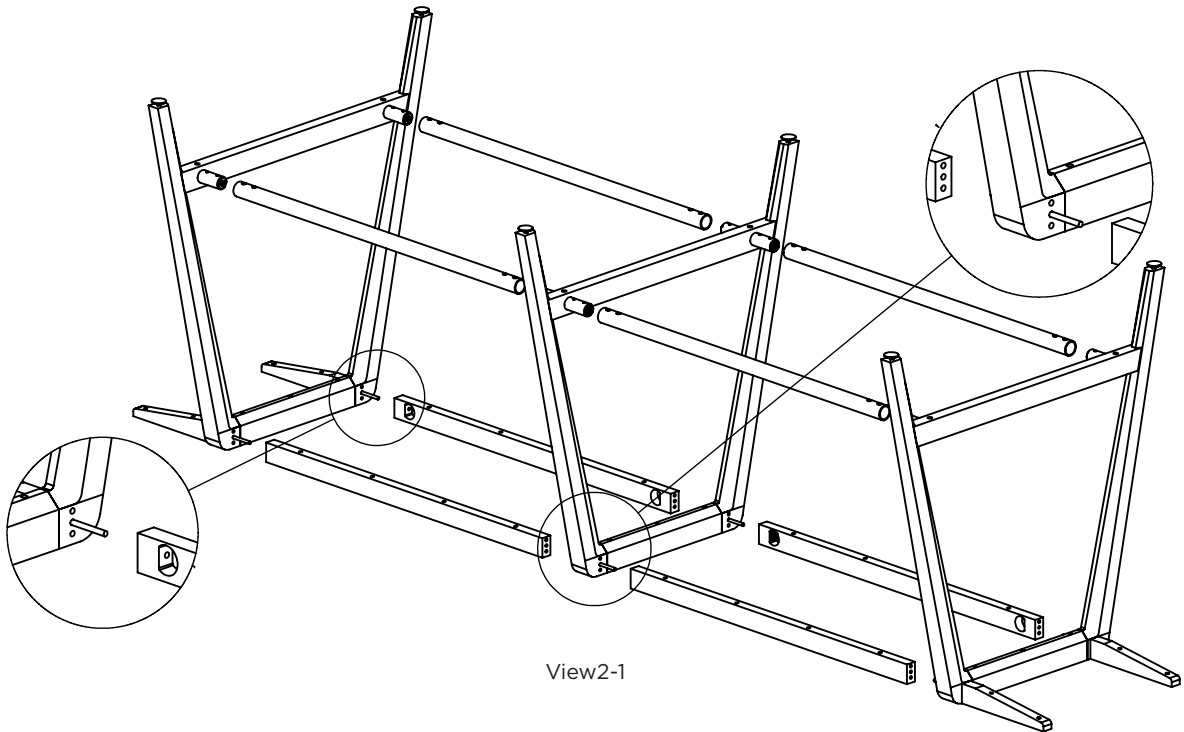

View2-1

Library table tackboard assembly

Tools required:

- ½" Combination wrench
- ⅝" - ⅜" Allen wrenches

1. Begin by locating the through holes on the bottom of the worksurface. Next, insert the mounting pin into the hole, making sure the longer portion of the pin is facing up. Lastly, utilizing the pre-drilled holes in the worksurface, fasten the mount pin to the top using the supplied screws from the HK-118 kit, as shown below.
2. With all the mount pins fully secured, the tackboard(s) can now be installed. Align the bored holes on the bottom edge of the tackboard to the mount pins and drop the tackboard into position.

NOTE: The optional Powdercoated Standoff will need to be slid onto the pins prior to the tackboard, as shown below.

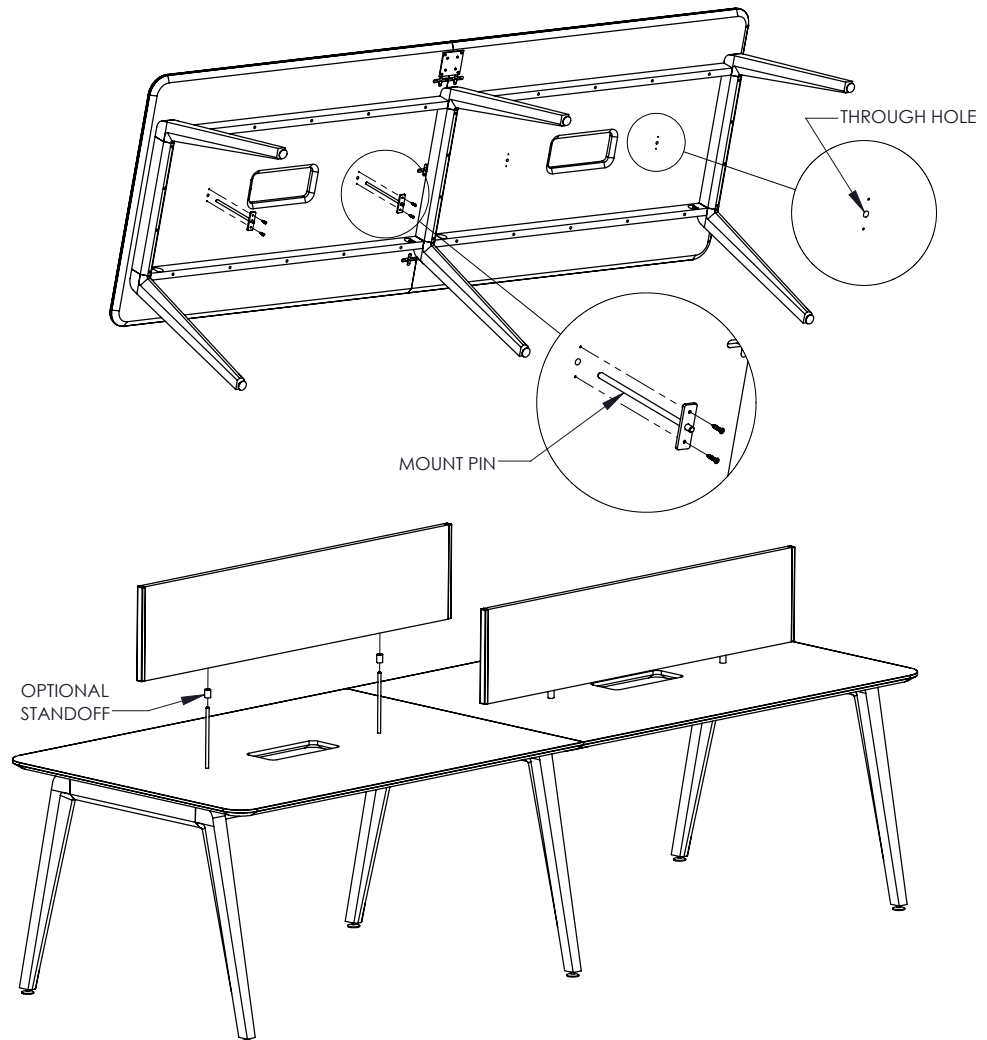

Wire management assembly

Tools required:

- Drill
- Tape measure

The following steps are used to install the EW-LWM1 wire managers to Eleven Wood Leg Assembly.

1. Dry fit the upper most leather strap to the upper portion of the leg. One of the buttons on the strap will be located along the centerline of the inside flat of the leg. The remaining button will be fastened onto the outside face of the leg. Depending on how many cables will be utilized, and how tight or loose of fit is desired, will determine where the buttons are permanently located.
2. When the fit of the strap has been determined, lightly mark the location on the leg. Then, screw the button socket along the centerline of the inside flat of the leg, as shown above. The remaining (2) button sockets can then be evenly spaced and fastened to the inside flat of the leg.
3. Going back to the dry fit step, approximate the location for the outside button sockets. Once the location has been determined, the outside button sockets can then be fastened to the outside face of the leg. The leather straps can now be snapped into place.

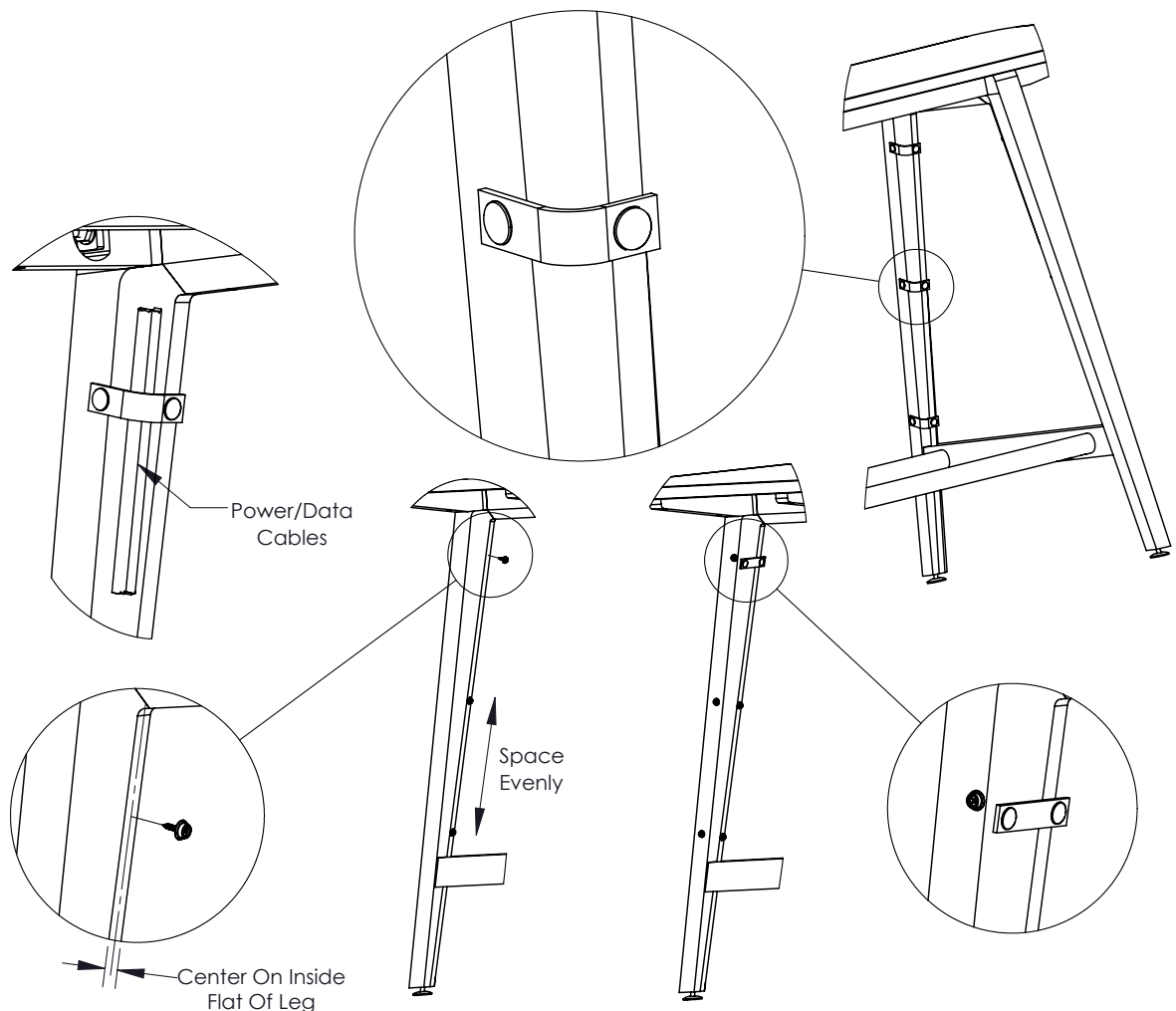

Wire management assembly

Tools required:

- Drill
- Tape measure

The following steps are used to install the EW-LWM2, EW-LWM3, or EW-LWM4 wire managers to an Eleven Wood

1. Place the Lock Channel on the wire manager onto the inside angled face of the desired leg. The tangent edge of the Lock Channel should be aligned with the intersecting edge of the angled and flat faces of the leg as shown above. It is suggested that the wire manager be centered vertically on the leg, but can be offset if desired.
2. When the wire manager has been aligned properly, begin fastening to the leg by screwing the supplied screw from the HK-38 kit through the Lock Channel and into the leg. The outer screws should be located approximately 1" in from the ends and the rest be spaced apart evenly. The screw should also be placed closest to the outside edge of the Lock channel to avoid any interference with the Hook Channel.
3. With the Lock Channel fastened, route all cables down the leg and begin wrapping the felt around them. Lock the Hook Channel into place by rotating it around and inserting into the Lock Channel, as shown below.

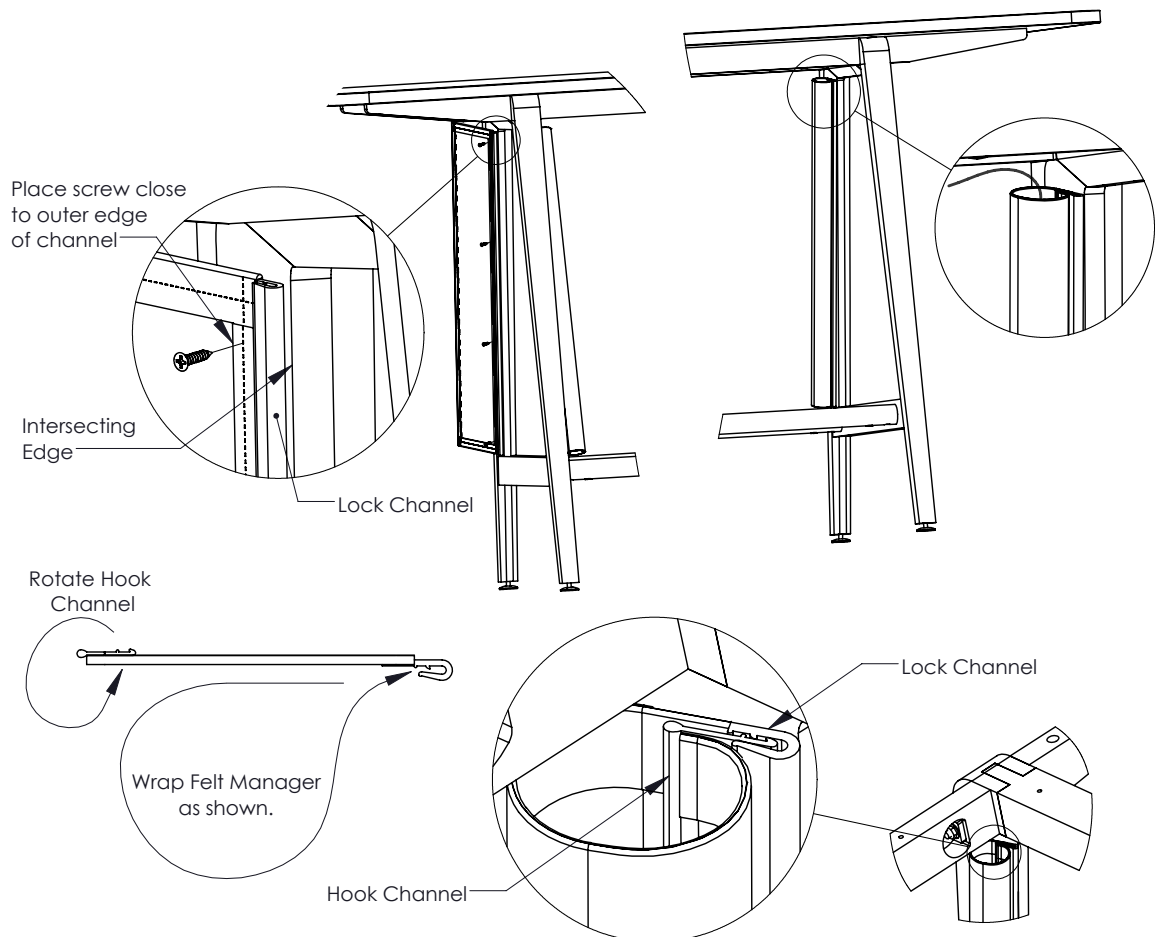

Wire management assembly

Tools required:

- Drill
- Tape measure

The following steps are used to install all of the EW-WM style wire managers to Eleven Wood Table.

1. Place placing the Lock Channel onto the inside face of the apron rail. Making sure the Lock Channel is centered and flush with the bottom of the apron rail, begin fastening to the rail by screwing the supplied screw from the HK-38 kit through the Lock Channel and into the apron rail. The outer screws should be located approximately 1" in from the ends and the rest be spaced apart evenly. The screw should also be placed closest to the outside edge of the Lock channel to avoid any interference with the Hook Channel as shown below. Repeat this step for the opposite side.
2. With the Lock Channels fastened, route all cables down the length of the table and begin wrapping the felt manager around them. Lock the Hook Channels into place by inserting into the Lock Channels, as shown below.

